



Under Pump Check valve

Mod. 15



CE Ex II 3 G

APPLICATION

The check valve is designed to prevent the back flow of fluid on the suction system fuel line and permits its flow only in one direction. Top and lower isolation and testing of pipework are possible without disassembling of a suction line. The check valve can be installed between oval or triangular flanges. Flexible hoses to fix the under pump check valve are available on request.

PARTS	MATERIAL
BODY	ANODIZED ALUMINIUM
MOLLA	STAINLESS STEEL
OR	VITON®
POPPET GUIDE	VITON®

CHEMICAL SUITABILITY

- Standard model (BRASS) is for traditional fuel without additives.

FLOW RATE
190 l/min (gravity up to di 3,5 mt)
540 l/min (2bar pressure)

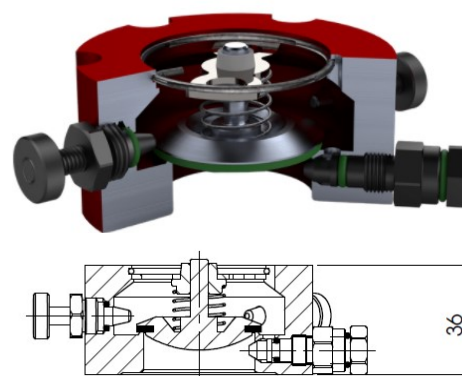
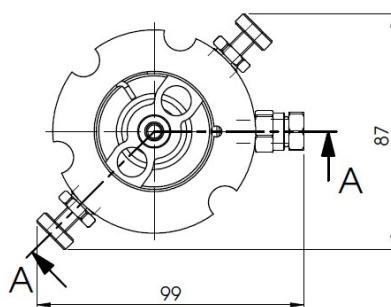
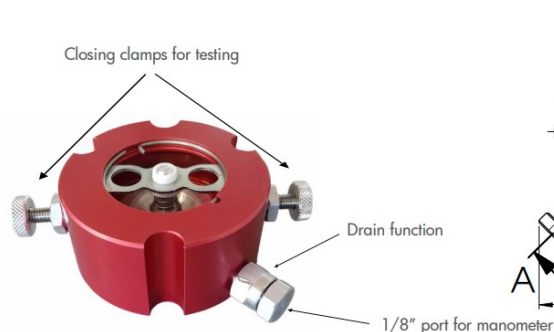

PRODUCT	CODE
UNDER PUMP CHECK VALVE	15-40
TRIANGLE FLANGE 1" 1/2	010980
GASKET VITON® or NBR	010980 FKM / 010980 NBR
OVAL FLANGE 1" 1/2	090373
GASKET CORK or VITON®	090373SG / 090373CV



INSTALLATION

- For correct installation follow the Directives and product User Manual.
- For custom application or maintenance write to: quality@ridart.it.
- Declaration of Conformity and User Manual are available on: www.ridart.it/support

MAINTENANCE

- Periodically check the device is necessary to remove possible dirty.
- Always replace the product after fire, deflagration, brake or damage.
- In case of tampering warranty expires and safety protection is not guaranteed.



RIDART s.r.l. via Adua, 17 - 21045 Gazzada Schianno (VA) ITALY P.IVA/C.F. IT 01454770122
www.ridart.it info@ridart.it +39 0332 463301

Product Certification, Declaration of Conformity, User Manual and Testing on: www.ridart.it/support
 The Data and Images are not binding. We reserve the right to make changes without notice. Pressure & Flow Tolerances ±20%.