

# 31

## SHEAR VALVE

### Stainless Steel



CE  II 2G

The Ridart stainless steel shear valve is installed below the dispenser on the delivery line, in case of fire or external accident, prevents fuel loss.

Shear valves shut off the flow of liquid (e.g. AdBlue®) in the event of a vehicle collision with a dispenser preventing an excessive and uncontrolled release into the environment.

The optional e-coated mounting bracket allows installation both in containment sumps beneath the dispenser as well as direct mounting to the concrete forecourt. The valve is available in the threaded version BSP 1" X 1 1/2".

It is a Safety Accessory in according with Directive 2014/34/EU and EN ISO 13617-2.



## Specification

PRODUCT	31
CODE	31-25-40
BODY	STAINLESS STEEL
BUSH	ALLUMINIUM
SHUTTER	STAINLESS STEEL
GUIDE	STAINLESS STEEL
SPRING	STAINLESS STEEL
SEEGER	STAINLESS STEEL
O-RING	VITON®
THREAD	FEMALE 1" BSP X 1" 1/2 BSP
HEIGHT mm	90

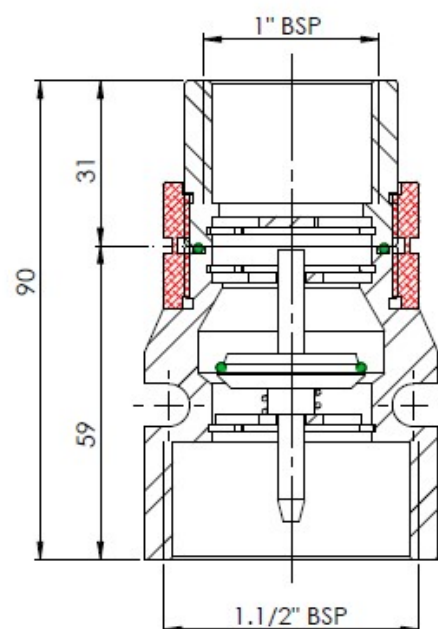

## Chemical Suitability

- Standard model (BRASS) is for traditional fuel without additives.

## features

- Break force as rule required between 330 Nm ND 880 nm
- Break force within parameters established by UL842
- Must be installed with rigid pipe

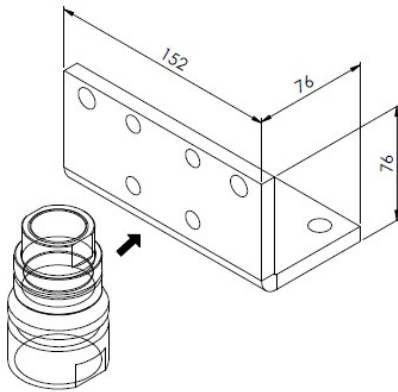

CODE 31-25-40-04  
**BREAKING BUSH**  
SPARE IN CASE OF BREAKING VALVE

CODE 31-25-40-08  
OPTIONAL **VALVE SUPPORT**



## Installation

- For correct installation follow the Directives and product User Manual.
- For custom application or maintenance write to: [quality@ridart.it](mailto:quality@ridart.it)
- Declaration of Conformity and User Manual are available on: [www.ridart.it/support](http://www.ridart.it/support)

## Maintenance

- Periodically check the device is necessary to remove possible dirty.
- Always replace the product after fire or deflagration.
- In case of tampering warranty expires and safety protection is not guaranteed.