

1605 dn50 QUICK DRY COUPLER FEMALE



CE  II 2 G

It's a Safety accessory in according with Directives ATEX 2014/34/EU and PED 2014/68/UE. The dry quick coupling is used to prevent any possible leaking during the process of transferring hazardous fluids in different fields of application (petrochemical, food, pharmaceutical, beverage & more).

- Valve opens and closes automatically
- No residual loss on disconnection
- Connected & disconnected in pressure
- Female coupler available 2" (dn50) and 3" (dn80)

The best performances allowed by the new regulation:

- Max operational temperature 60°C
- Max operational pressure 8 bar



DRY BREAK
MALE

DRY BREAK
FEMALE



DRY BREAK
FEMALE/MALE CONNECTED

Chemical Suitability

- Standard model is for traditional fuel without additives.
- "SS" model is for aggressive solvents, acids or bases.

Specification

PRODUCT	1605 AL	1605 SS
BODY	ALUMINIUM	STAINLESS STEEL
SCREW	STAINLESS STEEL	STAINLESS STEEL
POPPET	ALUMINIUM	STAINLESS STEEL
O-Ring	VITON®	VITON® (Option: SFEP)
SPRING	STAINLESS AISI 302	STAINLESS AISI 302

PRODUCT	1605 2"	1602 2"
CODE	1605-50 AL 1605-50 SS	1600-50 AL 1600-50 SS
TYPE	FEMALE	MALE
COUPLER	2" F NATO STANAG 3756 Ø 70 mm	2" M NATO STANAG 3756 Ø 70 mm
THREAD	2" F BSPP	2" F BSPP
HEIGHT mm	126	92
FLOW l/min Gravity	420	420
FLOW l/min (8 bar)	800	800

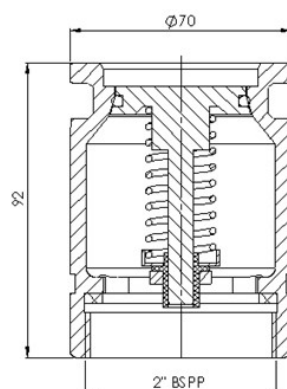
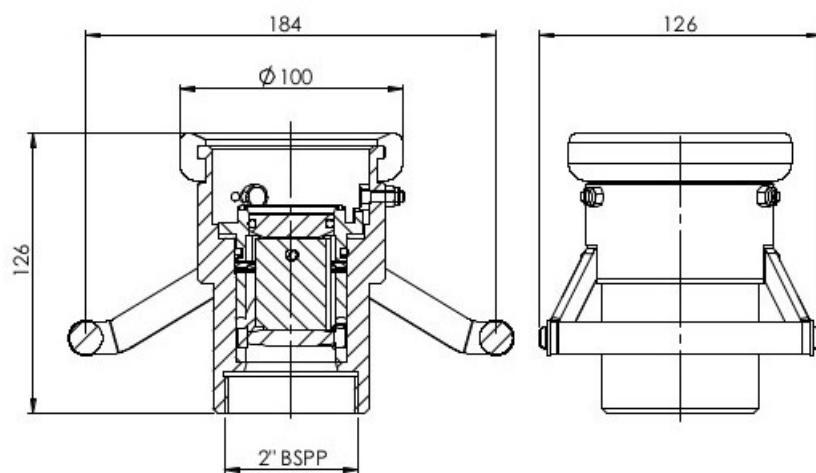

PRODUCT	1610	1610N
CODE	1610-80	1610N-50
DESCRIPTION	BLACK CUP	RED CUP
MATERIAL	BLACK RUBBER	RED RUBBER
DIMENSION	Ø 119 mm	Ø 70 mm
HEIGHT mm	18	16.5
		

Installation

- For correct installation follow the Directives and product User Manual.
- Contact our technical department for custom application or maintenance by email to:

quality@ridart.it.

- Product Certification, Declaration of Conformity and User Manuals are available on:

www.ridart.it/support.

Maintenance

- Periodically check the device is necessary to remove possible dirty.
- In case of tampering warranty expires and safety protection is not guaranteed.